



## THE MARCO at SEVEN PINES

THE MARCO - TRANSITIONAL

**3 Bedrooms • 2 Bathrooms • 2-Car Garage • 1,792 ft<sup>2</sup> Living Area • 2,467 ft<sup>2</sup> Under Roof**

The Marco floor plan is a beautifully designed 3-bedroom, 2-bath home that effortlessly balances style and functionality. The open-concept layout connects the kitchen, dining, and living areas, creating a spacious environment perfect for family gatherings. The master suite serves as a private retreat, complete with a deluxe bath and walk-in closet. With a dedicated study, covered lanai, and ICI Homes' customizable options, the Marco offers the flexibility to fit your lifestyle. Enjoy the freedom to personalize everything from the kitchen layout to outdoor spaces, making this home uniquely yours.

\* Renderings may vary from actual home. Please see disclaimer for more details.

**\$2,115**

**ESTIMATED SAVINGS**



This home has a HERS Score of 60 and is estimated to save you \$2,115 on your annual utility bills vs. a resale home.

# THE MARCO

**3 Bedrooms • 2 Bathrooms • 2-Car Garage**

**Seven Pines**  
Jacksonville, FL

**Available in**  
Seven Pines 40 RL

**Living Area: 1,792 ft<sup>2</sup> Under Roof: 2,467 ft<sup>2</sup>**

## THE FARMHOUSE



## THE CRAFTSMAN



## FIRST FLOOR

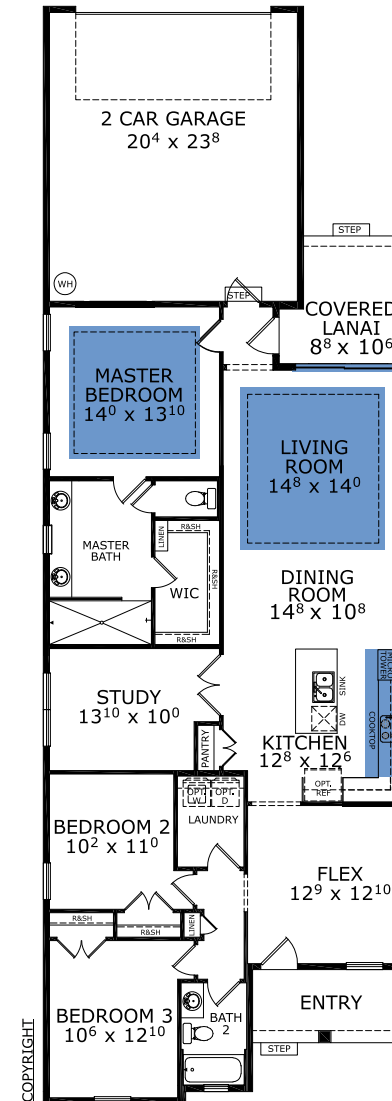

# Floor Plan Comparison Tool

Close

Customize this plan, it's easy! (844) 349-6401 or visit [ICIHomes.com](http://ICIHomes.com)

include lot premiums, upgrades, and options. Inventory home completion date may vary. All prices subject to change without notice. All plans are property of ICI Homes and cannot be copied or used without permission. Prices, promotions, incentives, features, options, amenities, floor plans, elevations, site maps, designs, materials, and dimensions are for illustrative purposes only and subject to change without notice. Plans should not be relied upon as representation express or implied of final sizes, locations, features or dimensions. Square footage and dimensions are estimated and may vary from description. All HERS ratings and savings are calculated by a third party energy rating service. Actual savings will depend on a number of factors, including but not limited to daily activities, home maintenance practices, household size, use of appliances, lighting and internal climate control systems, lot orientation, and surrounding climate and weather conditions. **Created on 01/28/2026:** \_\_\_\_\_ **Garage Orientation R / L:** \_\_\_\_\_

