



## THE NASSAU at SEVEN PINES

THE NASSAU - FARMHOUSE

**3 Bedrooms • 2 Bathrooms • 2-Car Garage • 1,603 ft<sup>2</sup> Living Area • 2,307 ft<sup>2</sup> Under Roof**

The Nassau floor plan is a charming 1,603-square-foot home with three bedrooms and two baths, designed for comfortable, open-concept living. Step into a flexible space near the entry that's perfect as an office or guest nook, followed by the main living area where the kitchen, dining, and living room flow together effortlessly. Enjoy the covered lanai accessible from the living room, ideal for outdoor relaxation. The private master suite includes a spacious walk-in closet and an en-suite bath with dual vanities. With options for personalized upgrades, the Nassau floor plan lets you create a space that feels uniquely yours.

\* Renderings may vary from actual home. Please see disclaimer for more details.

**\$2,019**

**ESTIMATED SAVINGS**



This home has a HERS Score of 59 and is estimated to save you \$2,019 on your annual utility bills vs. a resale home.

# THE NASSAU

**3 Bedrooms • 2 Bathrooms • 2-Car Garage**

**Seven Pines**  
Jacksonville, FL

**Available in**  
Seven Pines 40 RL

**Living Area: 1,603 ft<sup>2</sup> Under Roof: 2,307 ft<sup>2</sup>**

## THE COASTAL



## THE CRAFTSMAN



## THE TRANSITIONAL



## FIRST FLOOR

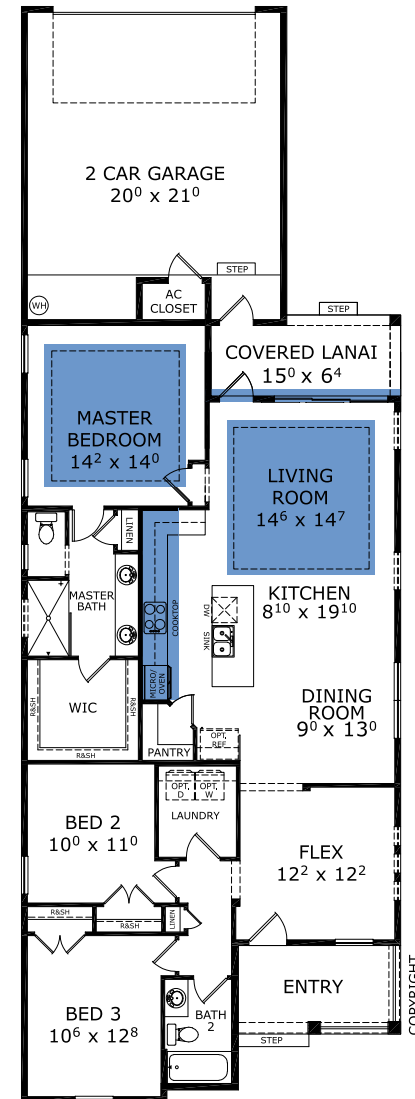

# Floor Plan Comparison Tool

Close

Customize this plan, it's easy! (844) 349-6401 or visit [ICIHomes.com](http://ICIHomes.com)

include lot premiums, upgrades, and options. Inventory home completion date may vary. All prices subject to change without notice. All plans are property of ICI Homes and cannot be copied or used without permission. Prices, promotions, incentives, features, options, amenities, floor plans, elevations, site maps, designs, materials, and dimensions are for illustrative purposes only and subject to change without notice. Plans should not be relied upon as representation express or implied of final sizes, locations, features or dimensions. Square footage and dimensions are estimated and may vary from description. All HERS ratings and savings are calculated by a third party energy rating service. Actual savings will depend on a number of factors, including but not limited to daily activities, home maintenance practices, household size, use of appliances, lighting and internal climate control systems, lot orientation, and surrounding climate and weather conditions. **Created on 01/28/2026:** \_\_\_\_\_ **Garage Orientation R / L:** \_\_\_\_\_

